

2/2 Way Pneumatic Piston Operated Normally Closed Valves

DATA SHEET
6612E

With Cylinder Actuator, Angle Type For On-Off Application
(Rust Free Design)

SPECIFICATIONS

Sizes : 15 mm (1/2") to 50 mm (2")

CONSTRUCTION

Body and Bonnet : Investment casted ASTM-A, 351CF8 (St.St. 304) CF8M St.St. 316).

Pressure Temperature Rating : As per ANSI class 300.

End Connections : Standard BSP(F)/ NPT(F).

Seating : Soft seated Teflon backed by EPDM. Optional-VITON /EPDM, Buna Nitrile.

Leakage : As per ANSI B16.104 - 1976 Teflon seating class IV. For other soft seating class VI Drop Tight/ Bubble Tight.

Trim : S.S. AISI 304/316.

Stem Packing : Self adjusting, Spring loaded Teflon packing.

Characteristics : On-Off, normally closed.

Working Fluid Pressure : Refer to table below.

Working Temperature : On steam-continuous 155°C Intermittent 180°C. with Teflon seating, Buna Nitrile 80°C., EPDM 135°C., VITON 180°C.

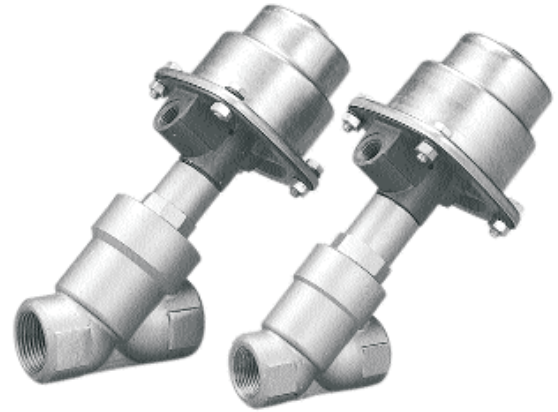

ACTUATOR

Spring return type, Pneumatic Cylinder.

Cylinder Cover : S.S. AISI 304 (deep drawn).

Cylinder Flange : Pressure die casted, aluminium silicon alloy, solution treated and hard anodised.

Piston : Steel (deep drawn).

Piston Packing : Buna Nitrile.

Actuator Spring : IS 4454 Grade III, duly painted..

Actuator Working Pressure : 3.5 to 6 bar, (refer to graph).

Signal Pressure

Operating Cycles per hour : 15mm, 20mm, 25mm upto 600 cy/hr. 35mm and 50mm upto 500 cy/hr. (tested on air, on other fluids, this figure may vary).

Life Expectancy : Over one million cycles (lab tested in ideal condition).

Air Quality : Lubricated /Non-lubricated.

Maximum Operating Pressure Differential : Refer to graph.

Accessory : Position indicating limit switch box, solenoid valve, filterregulator gauge. Other accessories available on application.

Application : For control of air, water, oil, gas, steam in textile, power generation, paper & pulp, chemical, petro chemical industries, PSA nitrogen system, air dryer, gas generator and others.

Back Pressure : All models except E35 mm and E50mm inlet pressure and back pressure is same. For model E35mm & E50mm max, back pressure is 2.5 bar.

Instruction Manual : Refer to IM 6612E.

SPECIFICATION TABLE

Catalogue Number	Size BSP (F)		orifice Size mm	flow Factor Kv m ³ /hr	Maximum Working Pressure bar	INLET POSITION	Safe Working Pressure bar	Actuator Type Cy	Air Consumption litres/cy
	Inch	mm							
6612E 15	1/2	15	16	4.3	16	FLTOCL	16	70	0.150
6612E 155	1/2	15	16	4.3	16	FLTOOP	16	70	0.150
6612E 20	3/4	20	16	5.4	16	FLTOCL	16	70	0.150
6612E 205	3/4	20	16	5.4	16	FLTOOP	16	70	0.150
6612E 25	1	25	23	13.6	16	FLTOCL	16	70	0.160
6612E 255	1	25	23	13.6	10	FLTOOP	16	70	0.160
6612E 35	1½	35	34	31.8	15	FLTOCL	16	70	0.172
6612E 355	1½	35	34	31.8	4	FLTOOP	16	70	0.172
6612E 50	2	50	45	54.5	6	FLTOCL	16	70	0.184
6612E 505	2	50	45	54.5	3	FLTOOP	16	70	0.184
6612E 354	1½	35	34	31.8	14	FLTOCL	16	100	0.310
6612E 3545	1½	35	34	31.8	16	FLTOOP	16	100	0.310
6612E 504	2	50	45	54.5	10	FLTOCL	16	100	0.329
6612E 5045	2	50	45	54.5	10	FLTOOP	16	100	0.329

DIMENSIONS (IN MM)

CATALOGUE NUMBER	SIZE		A	B	C	D	E	WEIGHT (Kgs)
	Inch	mm						
6612 E 15 6612 E 155	1/2	15	63.5	16.8	155	103.5	174	1.360
6612 E 20 6612 E 205	3/4	20	75.0	18.0	160	103.5	180	1.510
6612 E 25 6612 E 255	1	25	90.0	21.5	165	103.5	190	1.820
6612 E 35 6612 E 355	1½	35	125.0	29.0	180	103.5	216	2.580
6612 E 50 6612 E 505	2	50	150.0	35.0	190	103.5	235	3.490
6612 E 354 6612 E 3545	1½	35	125.0	29.0	230	138.0	268	3.640
6612 E 504 6612 E 5045	2	50	150.0	35.0	240	138.0	285	4.280

- OPEN TOLERANCE ± 3 mm ALL OVER

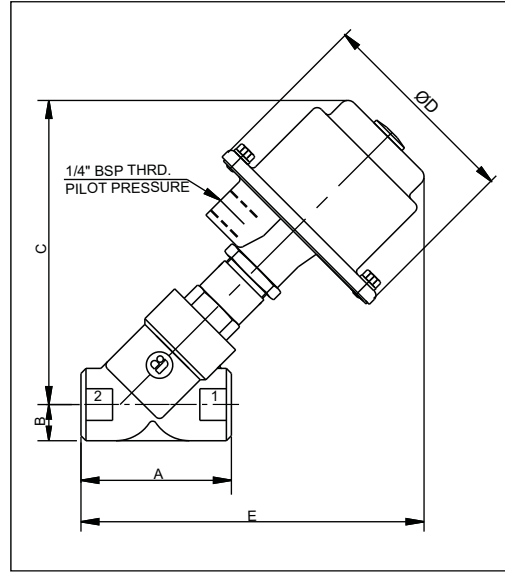

6612E

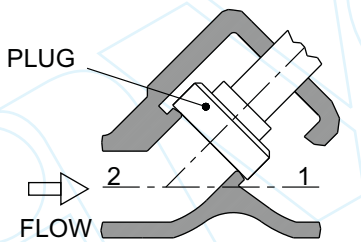
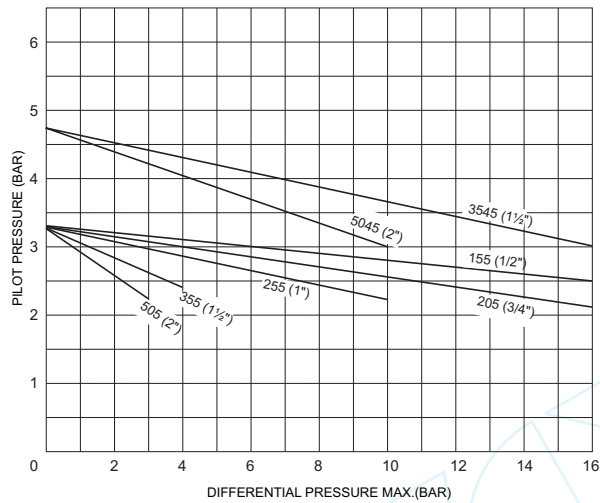

NORMALLY CLOSE-FLOW TO OPEN PLUG
CAT. NO. 6612E (FL TO OP)

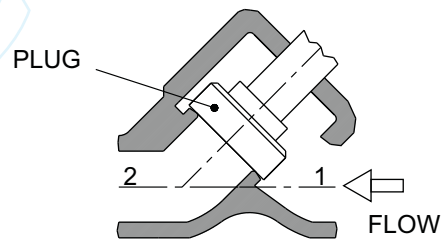
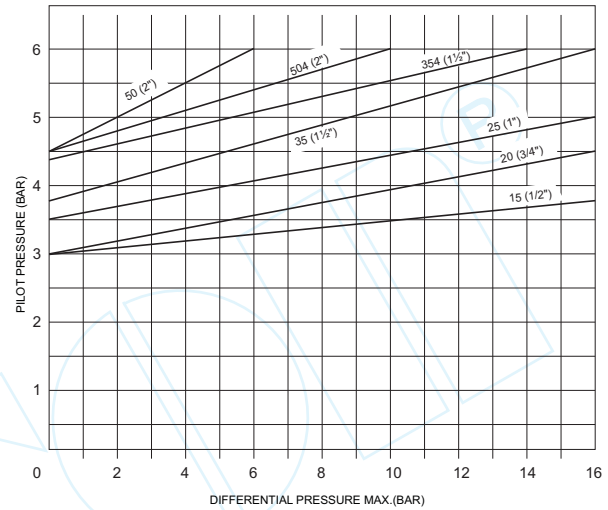

NORMALLY CLOSE-FLOW TO CLOSE PLUG
CAT. NO. 6612E (FL TO CL)

Note:

Technical specifications, details & dimensions are subject to change without prior notice.
Dimensions in the table are approximate subject to final confirmation by AVCON.